

basic C

A clear structure creates space

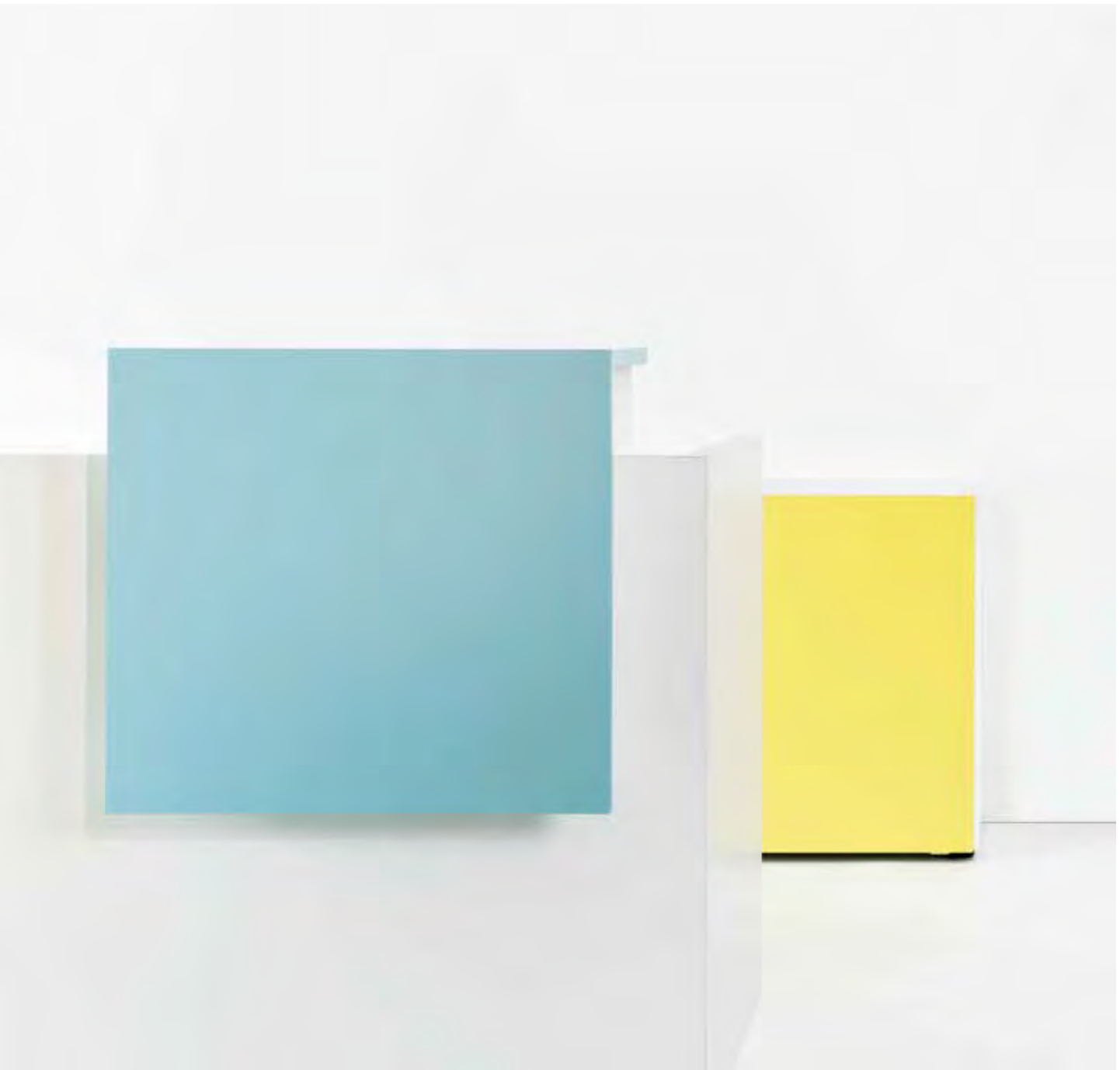





FLEXIBLE AND MODULAR INTERIOR DESIGN

With the modular construction system **basic C**, one can design flexible workplaces and reception solutions matching with any room situation.

A simple and effective combination of elements enables an unlimited diversity. This allows linear, angled, alternate and even stackable solutions that can be reconfigured by rapid mounting and demounting at any time.

With **basic C** new spaces providing functional utilisation can be achieved: in combination with additional worktops or by the perfect integration of our cupboard system basic S.

RECEPTION SYSTEM

An up-to-date reception system is communicative, radiates openness and thus becomes a perfect interior design solution.

Clearly structured and highly flexible, counter elements and modesty panels, for example, can be placed in any position. Using different surface materials – from melamine decors to high-quality veneers – they match with any interior architecture.



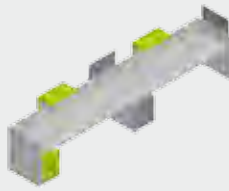
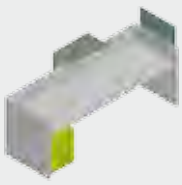

basic C

Basis module, linearly extended and as an angle combination.





A modern office workstation featuring a white desk with a teal privacy panel and a laptop. The desk is part of a larger modular system. The background is a bright, minimalist office space with large windows and a clean, white aesthetic. The teal panels provide a pop of color and privacy.

DOUBLE WORKPLACE WITH MODESTY
PANELS. COMBINED WITH MODULES FROM
THE **basic S** STORAGE SPACE SYSTEM.



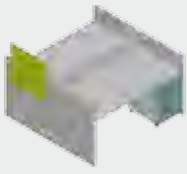

basic C
Opposite double workplace.

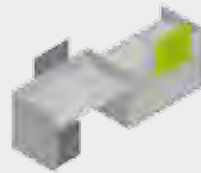

basic C
Alternate double workplace.



WORKSYSTEM

A simple and effective combination of elements enables the configuration of single workplaces as well as opposite and alternate double workplaces. In this way, **basic C** meets nearly any workplace requirements.

The construction of the supporting side panel offers a high degree of discretion, thus becoming an element that divides the room. The worktops are height-adjustable. By means of suspended cable ducts, a continuous electrification flap enables the access to the power supply at any time.







ROOMSYSTEM

The supporting side panels can be easily stacked by means of a vertical connection system. The horizontal seam created in this way is underlined by an 8 mm thick shadow gap profile. The resulting room, in turn, can be designed with worktops or with modules from the cupboard system basic S.

By means of the trussing construction, worktops with a width of up to 240 cm (standing height) can be perfectly integrated in this system.

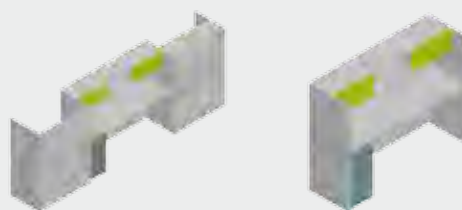

basic C

As an element dividing the room, with standing workplace and integrated storage space.





CONTAINER

The container offers storage space for documents and personal items directly at the workspace. Through the mitred joints, the freely designed frontal surface infinitely passes into the cover plate. By means of the lateral protrusions of the front section, the metal drawers can be comfortably pulled out, thus becoming the major design element.

The roller containers and the standing containers can be integrated into the **basic C** system and fulfill their function as an optimal means of organisation providing a space-saving modern aesthetic.

basic C

IM DETAIL



COUNTERELEMENT

Counter elements can be freely placed on the supporting side panel and offer the user an additional storage pocket. They can be attached without tools and can be easily moved. The panel, which is worked to mitre, is available in melamine, in MDF varnished or in veneer.

MODESTY PANEL

Modesty panels that can be freely placed on the supporting side panel. They are also attached without tools and can easily be moved.

STORAGE TRAYS

Accessories made of metal and white powder coating, can be freely placed on the supporting side panel. They are mounted without tools, are available in two sizes and can be used as a DIN A4 and a pen tray.

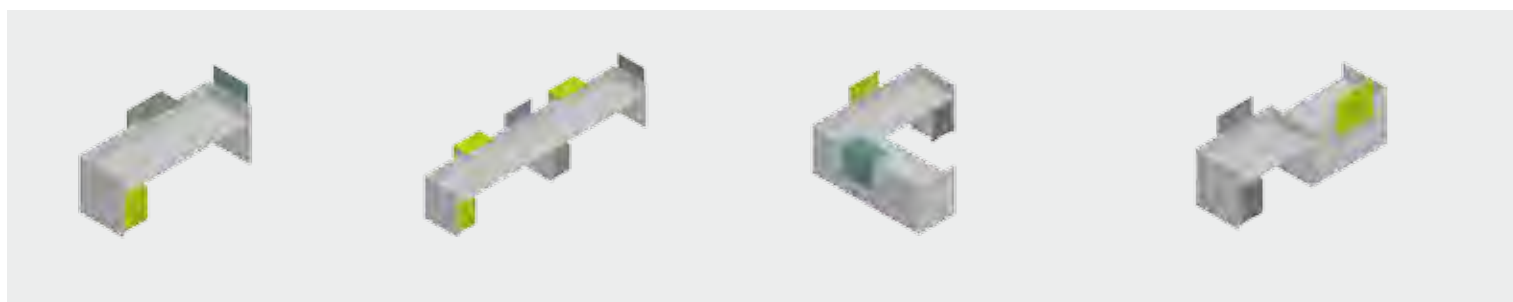



SUPPORTING SIDE PANEL

Supporting side panels in melamine, 3.8 cm thick, 95 cm high and up to 240 cm wide. They are linked on mitre with a technically smooth connection, or linearly. This enables an un-complicated reconfiguration at any time. The supporting side panels are constructed in lightweight designs and are height-adjustable by means of sliding positioners.



WORKTOP

Worktop 120 cm to 240 cm wide, 80 cm deep and 2.5 cm thick. The continuous electrification flap can be retracted by 180 degrees and thus offers the perfect access to the cable duct. The grooved brush ensures an optimal connection to the rearward cheek and thus enables the cable guidance.



TRUSSING CONSTRUCTION

Steel truss 120 cm to 240 cm wide, white powdered. It is connected to a screw plate milled flush into the supporting side panel on the right or the left hand side. This construction element offers a height adjustment between 70 cm and 78 cm, in steps of 1 cm each. Finally, cables trays can be mounted to the truss without using tools.



